



SERVICE LETTER

FOR THE

INSTALLATION OF A VACUUM BREAKER VALVE

ON THE

MODEL 328 FAS HOVER REFILL ELBOW

Model Used On: 328 FIRE ATTACK SYSTEMS
Effectivity: S/N 001
Document No.: SL 2006-003

Production Manager:

A handwritten signature in black ink, appearing to read "James R. DeBruin", written over a horizontal line.

Date:

11/14/06

Director of Sales:

A handwritten signature in black ink, appearing to read "Michael A. Hoff", written over a horizontal line.

Date:

11/14/06

Director of Engineering:

A handwritten signature in black ink, appearing to read "W.C. [unclear]", written over a horizontal line.

Date:

14 Nov '06

The information contained in this letter is proprietary to Simplex Manufacturing Co. Inc. Disclosure, reproduction, or use of this data for any purpose other than the operation and maintenance of the Simplex Manufacturing System is forbidden without prior written authorization from Simplex Manufacturing Co. Inc., Portland, Oregon.



No: SL 2006-003

Initial release Date: 11/13/06

Page 2 of 4

13340 NE WHITAKER WAY
PORTLAND, OREGON 97230
Phone (503) 257-3511 FAX (503) 257-8556 mail@simplexmfg.com

Date: 13 November 2006

Revision: Initial Release

PART NUMBERS AFFECTED: 328-704001-001 HOVER PUMP ELBOW INSTALLATION
328-704004-001 HOVER REFILL ELBOW

SYSTEM MODEL: Model 328 Fire Attack System

EFFECTIVITY: S/N 001

COMPLIANCE: Not Mandatory

DESCRIPTION: The service letter provides instructions on how to install a vacuum breaker valve into the hover refill elbow. The vacuum breaker valve improves the drainage characteristics of the hover refill hose after a fill cycle.

APPROVAL: None Required

MANPOWER: Estimated 3 MHRS



No: SL 2006-003

Initial release Date: 11/13/06

Page 3 of 4

13340 NE WHITAKER WAY
PORTLAND, OREGON 97230
Phone (503) 257-3511 FAX (503) 257-8556 mail@simplexmfg.com

MATERIAL:

The following materials are required for the accomplishment of this letter and may be obtained through Simplex Manufacturing:

Quantity	Part Number	Description	Item No.
1	000-152301-000	Inline Vacuum Breaking Valve 303 Ss, 1/2" NPT Male Inlet Unthreaded	1
A/R	6802K12	1/2" PTFE Thread Seal Tape	2

SPECIAL TOOLS:

1. 1/4" Drill Bit
2. 1/2" Drill Bit
3. 23/32" Drill Bit
4. 1/2" NPT Tap
5. 1/2" Drill
6. Tapping Oil

WEIGHT AND BALANCE: Not affected

ELECTRICAL LOAD DATA: Not affected

REFERENCE: Not affected

PUBLICATIONS AFFECTED: Not affected

13340 NE WHITAKER WAY
PORTLAND, OREGON 97230
Phone (503) 257-3511 FAX (503) 257-8556 mail@simplexmfg.com

ACCOMPLISHMENT INSTRUCTIONS

- 1) Disconnect the hover refill pumps electrical connector T24P; the connector is located on the forward, left hand side of the Model 328 Fire Attack System
- 2) Remove the hover refill hose by releasing the camloc fitting on the hover refill elbow
- 3) Rotate the hover refill elbow so the inlet is parallel with the ground
- 4) Create a mark on the Center Line of the elbow, four (4) inches in from the face of the elbow; see figure 1

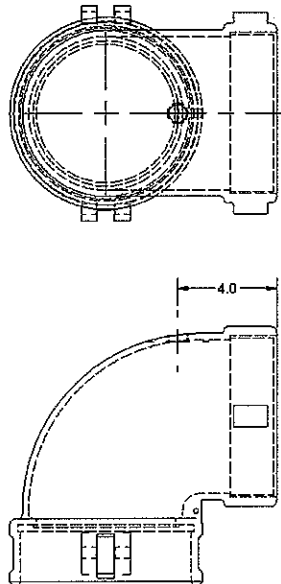

Figure 1

- 5) Drill a hole in the elbow starting with the 1/4 inch drill bit followed the 1/2 inch; finish the hole with the 22/32 inch drill bit; deburr the hole upon completion of drilling
- 6) Apply tapping oil as necessary and tap the hole using a 1/2 inch NPT tap
- 7) Thread the vacuum breaking valve into the tapped hole; wrap threads with PTFE Thread Seal Tape prior to installation
- 8) Connect the hover refill hose to the hover refill elbow
- 9) Connect electrical connector T24P