

From aerial agricultural applications to today's most advanced aircraft fire-fighting equipment, Simplex Aerospace, based in Portland, Oregon is an industry leader serving thousands of operators worldwide. Simplex's reputation as the world leader in design, manufacturing, and certification of aerial application systems has been built over a 70 year history of supplying innovative designs, high quality craftsmanship and reliable customer support. As an industry pioneer, Simplex introduced the first aluminum centrifugal pump designed for aerial applications. Today, Simplex maintains its industry leadership by incorporating the latest technology in design and manufacturing systems from high-strength, low-weight composite materials to produce the highest performance and most cost-effective airborne systems.



Simplex holds over 150 STC's for the company's products and has a wealth of experience working with local regulatory authorities around the world to certify aerial systems. Simplex has an FAA certificate as a Manufacturer's Maintenance Facility Repair Station for the repair of all company products and holds Parts Manufacturing Authority for each of the STC's owned. Customer base includes Military, Forest Service, Oil Companies, Governments, Fire Departments, Power Utility Companies and large and small operators throughout the world.



Simplex is in the process of investigating a specialized composite internal Fire Attack System (FAS) for the Embraer KC-390 aircraft which includes a fire retardant capacity of 4800 gal with a foam addition of 250 gal. The tank is easily installed and removed with the roll-on/roll-off capability via the aircraft's rear loading ramp.

Engineering Concept  
of KC-390 Fire Attack  
System Installed

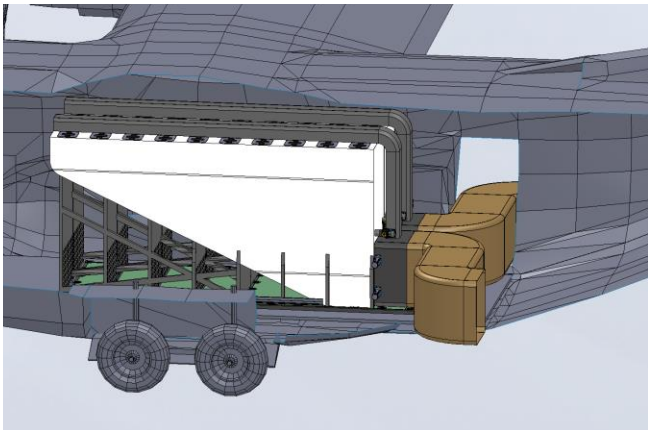
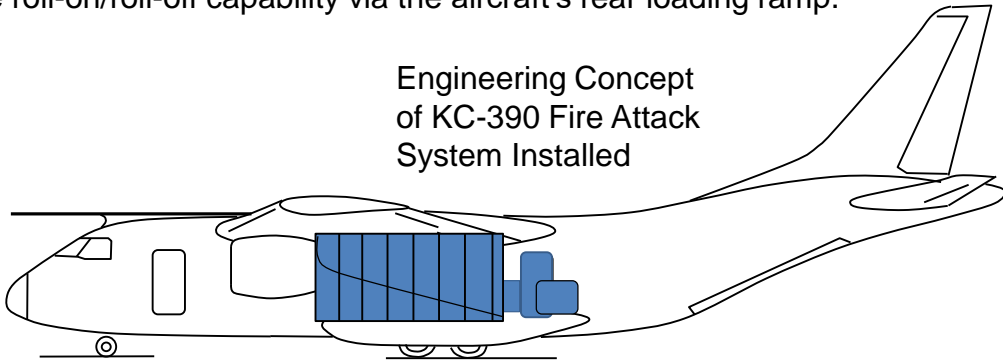

### Features & Specifications

- Easily returned to normal
  - Lightweight materials
  - Robust composite construction
  - Addition of foam retardant
  - Installed in ~60-90 min.
- Main Tank: 4,800 gal (18,160 L)  
Foam Tank: 250 gal (~950 L)  
Fill time: < 60-90 seconds  
Discharge: < 7 seconds

### Controls

- Programmable release
- Controlled by valves in exit duct
- Emergency dump
- Fluid Level Indicators
  - Main Tank
  - Foam Tank

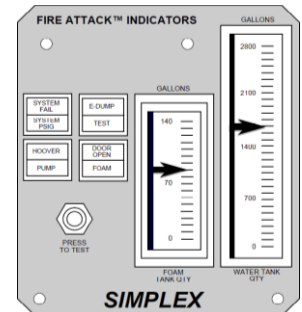
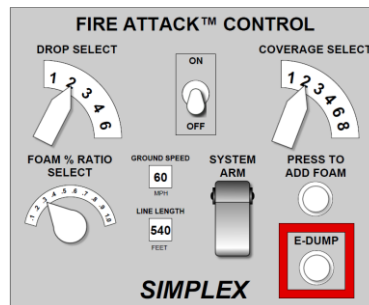

### Cockpit FAS Control-Indicator Panel

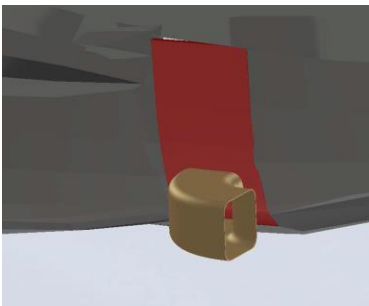

The Simplex KC-390 FAS represents the very latest in aerial fire-fighting technology and capability and is ideal for aircraft assigned to multi-mission tasks. The FAS can be installed or removed by a minimal crew in 60-90 minutes. The discharge is via gravity only and is fully evacuated in <7 seconds. The retardant exit is via "S" ducts installed in the replacement paratrooper doors.

For more information on the KC-390 FAS, contact:

[Phil.Moylan@MoylanMarketing.com](mailto:Phil.Moylan@MoylanMarketing.com) or +1-949-228-0622 (M)



[www.simplexmfg.com](http://www.simplexmfg.com)